

Ultimaxx 1900

Preparation



1 Unplug machine when batteries are fully charged



2 Open lid of machine

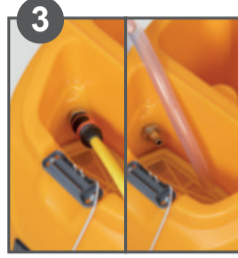

3 Fill tank with water



4 Dose chemicals manually



5 or with using IntelliDose +



6 Place the brush / padholders



7 Connect the hose to the squeegee



8 Start machine by pushing the key



9a Lower brush units by using the manual lever (by foot)



9b Or automatically



10 And lower the squeegee2



11 Start water, vacuum motor and choose water level

Operation



12 Use paddles to start cleaning



13 Lift brush unit



14 Lift squeegee



15 Empty the tank

Maintenance



16 Remove squeegee and rinse with water



17 Check filter and rinse with water



18 Remove brush and clean it



19 Remove filter



20 Empty filter and rinse with water



21 Check filter and rinse with water



22 Store machine with open lid



23 Plug machine in if needed

ATTENTION!

Do not use the machine before you have read and understood the operating instructions!
Questions: 1-800-558-2332

